

DESCRIZIONE

Portable table lamp

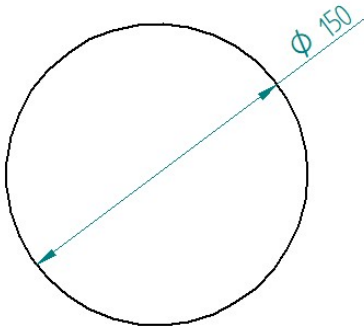

CERTIFICATION/ MARKING

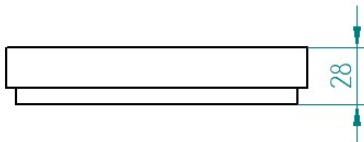
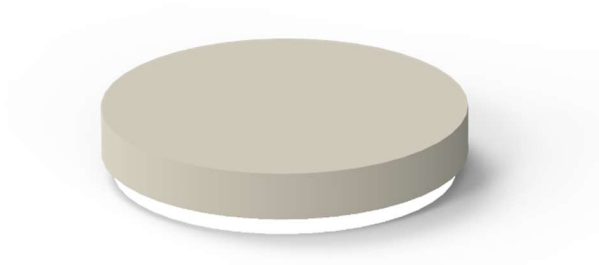
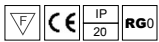

NOTES

Dimmable whit constant current power supply
not included

MAIN SPECIFICATIONS

| | |
|------------------|--------------------------------|
| - Lamp category: | LED |
| - Environment: | Indoor |
| - Mountings: | Ceiling recessed |
| - Power: | 4W |
| - CCT: | 2700K,3000K,3500K,4000K |
| - CRI: | 90 |
| - Net lumen (lm) | 350lumen |

OPTICAL

| | |
|------------------------|------------------|
| - Lighting type: | Direct |
| - LED type: | LED strip |
| - Light distribution: | Symmetric |
| - Optical type: | wide |
| - Luminous beam angle: | flood |

ELECTRICAL SPECIFICATIONS

| | |
|----------------------------|---------------------|
| - Power supply unit: | Not included |
| - Constant current supply: | 24VDC |
| - Insulation class: | III |

PHYSICAL

| | |
|-----------------------|---|
| - Overall dimensions: | Ø150 x 30 mm |
| - Recess opening: | |
| - Weight (kg): | |
| - Body Color: |  |
| - Material: | Aluminium |
| - Orientation: | |
| - Tilt (°): | |